



Medline® Transport Chair USER MANUAL



Steel Transport Chair



**Aluminum Transport Chair
with 12" Rear Wheels**



**Aluminum Transport Chair
with 8" rear wheels**



**Freedom I & Freedom II
Transport Chair**

Owner's & Maintenance Guide

DEALER: This manual must be given to the user of the transport chair.

USER: Please read this manual before operation for warnings, maintenance and safe usage instructions of this transport chair.

Congratulations on your selection of a Medline Transport chair.

Medline transport chairs are the result of extensive engineering and are manufactured to meet our rigid specifications and to surpass your expectations.

Medline transport chairs are designed to combine comfort, safety and reliability. Medline Industries, Inc. is committed to the quality of our products and to the satisfaction of our customers.

REORDER NUMBERS:

MDS808150E – 17” MDS808200E – 19” MDS808200W – 19” Excel Basic Steel Transport	Permanent restaurant style, swing-away detachable footrests, steel powder coat frame, black upholstery
MDS808150 – 17” MDS808200 – 19” Excel Steel Transport	Permanent full-length arms, swing-away detachable footrests, steel frame, black upholstery
MDS808210ARE - Red MDS808210ABE - Blue Excel Aluminum Transport 12” rear wheels	19” wide, permanent full-length arms, swing-away detachable footrests, aluminum frame, black upholstery, hand grip, wheel locks
MDS808200ARE – Red MDS808200ABE - Blue Excel Aluminum Transport 8” rear wheels	19” wide, permanent full-length arms, swing-away detachable footrests, aluminum frame, black upholstery
MDS808200SLRR – Red MDS808200SLBR - Blue MDS808200SLKR - Black MDS808200SLSR - Silver Freedom I Superlight Transport chair	19” wide, permanent desk-length arms*, swing-away detachable footrests, aluminum frame, black upholstery, cupholder *desk length arms allow for greater ease in getting into/out of the transport chair
MDS808200F2R – Red MDS808200F2B - Blue MDS808200F2P - Pink MDS808200F2S - Silver Freedom II Superlight Transport chair	19” wide, permanent desk-length arms*, swing-away detachable footrests, aluminum frame, black upholstery, stow-and-go clips, cup holder, side carrying bag *desk length arms allow for greater ease in getting into/out of the transport chair
MDS808210TC4 MDS808210TC3 Aluminum Transport 12” Rear Wheels	19” wide, permanent full-length arms, two-toned color upholstery, swing-away detachable footrests, aluminum frame, two-toned upholstery, hand grip wheel locks, convenient side pouch *MDS808210TC4 – White frame, MDS808210TC3 – Titanium Frame

Typical Product Specifications for Transport chairs:

MODEL	Excel Basic Steel	Excel Steel Transport	Excel Aluminum Transport	Excel Deluxe Aluminum Transport	Excel Superlight Freedom Transport
Model #	MDS808150E, MDS808200E	MDS808200	MDS808200ARE/ ABE	MDS808210ARE/ ABE	MDS808200*
Size (seat width)	17”, 19”	19”	19”	19”	19”
Seat depth	16”	16”	16”	16”	16”
Weight (w/o legrests)	25 lbs	25 lbs	19 lbs	23 lbs	14.8 lbs
Weight Capacity	300lbs	300lbs	300lbs	300lbs	300lbs
Armrests	fixed desk length	permanent full-length	permanent full-length	permanent full-length	fixed desk length
Arm pads	nylon, black	nylon, black	nylon, black	nylon, black	nylon, black
Legrests	steel, powder coat	steel, chrome plated	aluminum, red	aluminum red/blue/red	*Aluminum red(SLRR/F2R), blue (SLBR/F2B), black (SLKR), pink (F2P), silver (SLSR/F2S)
Frame	fixed /folding backrest	fixed /folding backrest	fixed /folding backrest	fixed /folding backrest	fixed /folding backrest
Upholstery	nylon, black, seat belt	nylon, black or plaid, seat belt	nylon, black, seat belt, hand loop	nylon, black or plaid, seat belt	nylon, black, seat belt, hand loop
Casters	plastic, black	plastic, black	plastic, black	plastic, black	plastic, black
Fork	plastic, black	steel, chrome plated	aluminum, silver	aluminum, silver	plastic, black
Foot plate	plastic, black	Aluminum	plastic, black	plastic, black	plastic, black
Brakes	rear wheel, wheel lock	rear wheel, wheel lock	rear wheel, wheel lock	hand grip	rear wheel, wheel lock
Warranty : Frame & Crossbar	Limited Lifetime	Limited Lifetime	Limited Lifetime	Limited Lifetime	Limited Lifetime
Warranty: Upholstery Parts & Components	1 year	1 year	1 year	1 year	1 year
HCPCS code	--	--	E1038	E1038	--
Miscellaneous					cup holder, wallet with key ring, cell phone bag on back upholstery

⚠️ WARNINGS

A CAREGIVER / TRANSPORTER MUST BE PRESENT AT ALL TIMES WHILE THE TRANSPORT CHAIR IS IN USE. NEVER LEAVE THE OCCUPANT UNATTENDED. THIS TRANSPORT CHAIR DESIGN IS NOT INTENDED TO ALLOW A PATIENT TO MANEUVER THE TRANSPORT CHAIR.

TO ENSURE YOUR SAFETY IN USING THIS MEDLINE TRANSPORT CHAIR, ALL WARNINGS AND SAFETY INFORMATION AND ALL INSTRUCTIONS MUST BE FOLLOWED. FAILURE TO DO SO MAY RESULT IN SERIOUS BODILY INJURY OR DAMAGE TO THE TRANSPORT CHAIR.

DO NOT USE THIS PRODUCT WITHOUT FIRST READING AND UNDERSTANDING THE INSTRUCTIONS CONTAINED IN THIS BOOKLET. IF YOU ARE UNABLE TO UNDERSTAND THE WARNINGS, CAUTIONS OR INSTRUCTIONS, CONTACT A HEALTHCARE PROFESSIONAL, DURABLE MEDICAL DEALER OR TECHNICAL PERSONNEL, OR CONTACT MEDLINE AT 1-800-MEDLINE BEFORE USE - OTHERWISE SERIOUS BODILY INJURY OR PRODUCT DAMAGE MAY OCCUR.

A QUALIFIED TRANSPORT CHAIR TECHNICIAN MUST PERFORM ANY REPAIR OR CHANGE TO THIS TRANSPORT CHAIR OR SERIOUS INJURY MAY OCCUR. TECHNICIANS: DO NOT SERVICE THE TRANSPORT CHAIR WITHOUT FIRST READING AND UNDERSTANDING THIS OWNER'S MANUAL. IF YOU ARE UNABLE TO UNDERSTAND THE WARNINGS, CAUTIONS, OR INSTRUCTIONS, CONTACT MEDLINE AT 1-800-MEDLINE.

DO NOT USE ACCESSORIES, PARTS, OR ADAPTERS OTHER THAN THOSE AUTHORIZED BY MEDLINE.

CONSULT WITH YOUR DOCTOR, PHYSICAL OR OCCUPATIONAL THERAPIST, OR OTHER QUALIFIED PROFESSIONAL REGARDING THE SELECTION OF THE TYPE OF TRANSPORT CHAIR AND ACCESSORIES BEST SUITED TO YOUR INDIVIDUAL NEEDS AND CAPABILITIES.

TABLE OF CONTENTS

Reorder Numbers	2
Product Specifications	3
General WARNINGS	4
Table of Contents	4
WARNINGS and Safety Instructions	5
WARNINGS and Safety Instructions con't	6
Guidelines: Safety and Handling of Transport chairs	7
Guidelines: Safety and Handling of Transport chairs con't	8
Guidelines: Safety and Handling of Transport chairs con't	9
 General Use Instructions	
Opening/Closing the transport chair.....	10
Folding/Unfolding seat back.....	11
Wheel Locks.....	12
Locking/Unlocking handgrip (specific models).....	14
Installing / Removing the swing-away leg rest riggings.....	15
Adjusting footplate assembly.....	15
 Safety Inspection and Maintenance	
Monthly Check list / Troubleshooting.....	16
Installing/Removing front wheels.....	17
Handgrip maintenance	18
Medline Limited Warranty.....	18
Safety Inspection Checklist.....	19

WARNINGS & SAFETY INSTRUCTIONS

⚠️ General Information

DO NOT use this product without first reading and understanding the instructions contained in this booklet. If you are unable to understand the Warnings, Cautions or Instructions, contact a healthcare professional, durable medical equipment dealer or technical personnel, or contact Medline at 1-800-Medline before use - otherwise serious bodily injury or product damage may occur.

Transport chairs are ideal for airports, shopping centers or other public places that require short term transport from one location to another. They are designed for safe and efficient transport with someone pushing the transport chair. Transport chairs are not intended for independent use by transport chair-bound individuals. The design does not allow maneuvering by the occupant.

DO NOT use the transport chair in a vehicle for transport. This transport chair has not been approved as a seat surface to be used within a vehicle of any kind. Always transfer the transport chair user to an approved vehicle seat and use restraints available from the auto industry for this application.

DO NOT exceed the weight capacity of the transport chair: 300lbs. The weight capacity includes the weight of the rider plus items carried or attached to the transport chair.

DO NOT use the transport chair while weight training. Medline transport chairs have not been tested for any type of weight training. If the weight capacity is exceeded, risk of fall, tip-over or loss of control may occur which can result in bodily injury or product damage.

Use of the seat belt is recommended to maximize safety and stability.

⚠️ Environmental

The transport chair is designed for use on firm, even surfaces such as concrete, asphalt, and indoor floors and carpeting.

DO NOT operate the transport chair on streets or roadways.

DO NOT operate the transport chair on loose, slippery, or uneven surfaces such as sand, gravel, hills, dirt roads, or ice.

DO NOT operate the transport chair on inclines greater than 10% (6 degrees) without assistance.

DO NOT attempt to go up or down inclines that are covered with oil, water, ice or any other potentially slippery substance.

DO NOT attempt to ride over curbs or obstacles. Doing so may cause your transport chair to tip over and cause bodily harm to you or damage to the transport chair.

DO NOT use the transport chair on stairs or escalators.

WARNINGS & SAFETY INSTRUCTIONS

⚠️ General Use

DO NOT stand on the frame of the transport chair.

DO NOT stand or put pressure on the footrests. When getting in or out of the transport chair, make sure the footplates are in the up position.

DO NOT attempt to lift the transport chair by any detachable components.

There are potential finger pinch point areas at moving parts and between the seat frame and the seat cradles on some models. When opening the transport chair, take care not to place your hand or fingers between the seat frame and the seat cradles (if present) or on any other moving parts.

ALWAYS keep hands and fingers away from moving parts. DO NOT sit in the transport chair until the seat is completely in the open position. Risk of injury may occur if care is not taken.

Ensure the seatback fold-down section is locked in the upright position before use.

The transport chair should be on a stable, level surface with the wheel locks engaged before transferring the user to or from the transport chair.

Completely engage the wheel locks when entering and leaving the transport chair or using the transport chair in an elevator or a wheelchair lift.

DO NOT transfer in or out of the transport chair on your own unless you have sufficient upper body strength, balance and agility and have been instructed in transfer techniques by a health professional. Every precaution should be taken to reduce the gap distance between the transport chair and the target seat or bed. Turn both casters parallel to the object you are transferring to.

DO NOT use the wheel locks (or hand grip locks if present) to stop the transport chair from moving. Wheel locks are not brakes. DO NOT use the wheel locks to slow your descent down an incline.

Changing direction when going down an incline could cause instability.

DO NOT lean forward out of the transport chair any farther than the length of the armrests.

DO NOT attempt to reach for objects if doing so means you must move forward in the seat.

DO NOT attempt to reach objects if you have to pick them up from the floor by reaching down between your knees.

DO NOT shift your weight or sitting position toward the direction you are reaching as the transport chair may tip over.

DO NOT attempt to lean over the top of the back upholstery to reach objects.

Before leaning or reaching forward, make sure to rotate the casters straight ahead toward the front of the transport chair and engage the wheel locks to prevent the transport chair from tipping over or moving.

WARNINGS & SAFETY INSTRUCTIONS



General Use

DO NOT tip the transport chair without assistance. DO NOT lean the transport chair back since this can cause the transport chair to tip over. If trying to reach objects, reach back only as far as your arm will extend without altering your seating position.

Any person assisting the rider in maneuvering or lifting of the transport chair must have sufficient strength and be able to see obstacles in the path of travel. When learning a new assistance technique, have an experienced assistant help you before attempting it alone. Remember to use good body mechanics.

Contact with water or excess moisture may cause the non-aluminum transport chairs to rust or corrode. DO NOT use the transport chair in a shower, pool or other body of water. Avoid excess moisture (example: do not leave the transport chair in a damp bathroom while taking a shower). Dry the transport chair immediately if exposed to moisture.

When cleaning the hand grips, use only a clean towel lightly dampened with cool water. Ensure the hand grips are dry before use. Use of soap or ammonia-based cleaning solutions may result in the hand grips sliding off.

If the transport chair is exposed to extreme temperatures, high humidity and/or becomes wet, check the hand grips to ensure they are not loose and do not twist on the handle.

Avoid storing or using the transport chair near open flames or combustible products.



Adjustments

DO NOT operate, maintain, or adjust the transport chair without reading and understanding all instructions in the manual.

DO NOT adjust the footrests any closer than 2 ½ inches from the floor.

DO NOT modify the transport chair. Examples: drilling holes, grinding, welding parts, using non-authorized / non-approved parts. Such modifications may change the transport chair's structure and center of balance, which may increase the risk of serious injury to the user and void the warranty.



Before EACH Use

- √ Make sure the transport chair rolls easily and that all parts work smoothly.
- √ Check for noise, vibration, or any change in use. Changes may indicate loose parts or transport chair damage.
- √ Check to ensure wheel locks are in good working order.
- √ Make sure hand grips are not loose and cannot be moved or twisted.
- √ Make sure the seatback is locked in the upright position.
- √ Have any problem found repaired promptly with authorized parts.

GUIDELINES: SAFETY & HANDLING OF TRANSPORT CHAIRS

Center of Gravity, Balance and Stability

The transport chair has been designed to be safe and stable during normal transport activity as long as proper balance is maintained. The point at which a transport chair will tip forward, backward, or to the side depends on its center of balance. To assure stability and proper operation of the transport chair, the center of gravity must be maintained in the transport chair. Center of gravity is the point at which all the weight of an object can be considered to be concentrated and represents the balance point.

Most activities such as transferring in and out of the transport chair, bending, and reaching affect the center of gravity and weight distribution of the transport chair. Addition of accessories such as a backpack will also re-distribute weight. Loss of proper balance may cause the transport chair to tip over. Use of the seat belt is advised to help maintain stability by minimizing movement within the transport chair seat. The use of anti-tip devices especially when maneuvering on ramps or inclines will also enhance safety.

Transport chairs are designed for safe and efficient transport with someone pushing the transport chair. Transport chairs are not intended for independent use by transport chair-bound individuals. The design does not allow maneuvering by the occupant.

To determine safety limits of the transport chair, practice with activities such as transferring, bending, and reaching with a healthcare professional that is knowledgeable about transport chair use.

To assure safe operation of the transport chair, ALL of the Warnings and Instructions in this manual must be followed. Failure to do so may result in tipping the transport chair over or causing the user to fall which may result in serious bodily injury or damage to the transport chair.

Some basic transport chair safety guidelines follow. The guidelines are critical for standard transport chair use, however, the principles also hold true for transport chairs. If any of the following activities are required while using the transport chairs, these guidelines must be followed to ensure safety and to avoid potential injury to the user or the transporter and to avoid damage to the transport chair.

Reaching / Leaning / Bending – FORWARD or SIDEWAYS

- Position the transport chair as close as possible to the object.
- Make sure the front casters are pointing in a forward position. This extends the wheel base and will help stabilize the transport chair.
- Make sure the wheel locks are engaged before activity.
- DO NOT attempt to reach for objects if doing so means you must move forward in the seat. DO NOT shift your weight toward the direction you are reaching.
- DO NOT attempt to reach objects if you have to pick them up from the floor by reaching down between your knees.
- DO NOT shift your weight or seat position toward the direction you are reaching.

GUIDELINES: SAFETY & HANDLING OF TRANSPORT CHAIRS

Reaching / Leaning – BACKWARD

- Position the transport chair as close as possible to the object.
- Make sure the front casters are pointing in a forward position. This extends the wheel base and will help stabilize the transport chair.
- DO NOT engage the wheel locks – if your weight shifts while reaching backwards it is better for the transport chair to roll than to tip.
- DO NOT lean back over the top of the back upholstery.
- Reach back only as far as your arm will extend without changing your position in the seat.

Transferring into and out of the transport chair

Transport chairs do not have detachable arms, requiring the user to be able to stand and assist with pivoting to the transport chair.

- Position the transport chair as close as possible.
- Make sure both wheel locks are engaged.
- Remove or swing away the footrests that are in the transfer path.
- DO NOT put weight on the foot rests.
- Transfer as far back into the seat or onto the bed/transport chair as possible.

Obstacles

Obstacles such as floor threshold strips, uneven floors, cords or items on the floor, or cracks in pavements can damage your transport chair and may cause loss of control or a tip over. Be alert! Scan your path and avoid any items that may cause instability.

Curbs, Steps and Stairs

Do not attempt to negotiate curbs or single steps without assistance. Ask your healthcare worker to provide instructions regarding safe transport chair use for curbs, steps and stairs. Proper body mechanics and awareness of the center of gravity is crucial for these maneuvers. The step tubes at the back of the transport chair are utilized to tilt the transport chair backwards until the balance point is achieved and the front casters clear the curb/step. Gently lower the front wheels to the ground and slowly roll the transport chair forward until the rear wheels roll up over the curb/step.

Extreme caution is required if it is absolutely necessary to maneuver an occupied transport chair up or down stairs. Two assistants with adequate body strength and endurance must be present. DO NOT lift the transport chair by any removable parts (i.e. swing-away footrests). Make sure the hand grips are not loose. Techniques for going up or down steps should be received from a health care professional familiar with transport chair use and practiced before attempting to transport on stairs. If at all possible, an alternate means of transport up or down stairs is recommended.

GUIDELINES: SAFETY & HANDLING OF TRANSPORT CHAIRS

Ramps / Inclines

The assistant must know their capabilities and limitations in terms of strength and endurance before attempting to go up or down a ramp. Slopes will change the center of gravity. DO NOT attempt to negotiate steep inclines greater than 10% (6 degrees, or one foot of rise or fall for every ten feet of ramp length) without an experienced assistant. Use of anti-tip devices are encouraged however, they may not prevent a tip-over. Sometimes anti-tip devices may catch at the beginning of a ramp. If this occurs, they will need to be disengaged and extra care should be taken. Backpacks or other gear on the back of the transport chair will cause it to tip backward more easily. Training and practice negotiating ramps with a healthcare professional is recommended.

- Go as straight up or down the incline as possible.
- Check the ramp for any obstacles, bumps, depressions, or wetness before beginning. Ask for additional assistance if necessary.
- Stay in the center of the ramp if possible.
- Avoid changing direction while on the ramp as this may cause loss of control of the transport chair.
- Avoid stopping on a ramp. Stopping may cause loss of control of the transport chair. If stopping is necessary, avoid sudden, abrupt forward movement when you resume propelling the transport chair as that could cause instability.
- When going up an incline, the occupant should lean forward. This will adjust the center of gravity to counteract the tendency of the transport chair to tip backward.
- When going down a ramp, the occupant should face forward and lean backward into the seat. Descent should always be done slowly. **DO NOT** use wheel locks as brakes to slow down or stop the transport chair. Attempting to use the wheel locks could result in accidental locking, veering or tipping to one side, or suddenly stopping.
- When going down a steep incline, the assistant should turn the transport chair and go down backwards to avoid tipping the occupant out of the transport chair.

Basic Information for Transport chair Assistants / Transporters

Work with the transport chair user's healthcare professional or your institution to learn safe ways to assist that are within your capability and comfort level. To prevent injury to yourself or the transport chair occupant use good body mechanics:

- Always tell the rider what you intend to do so he/she is ready for your actions and can assist with maintaining a balanced center of gravity for stability.
- Bend at the knees, not at the waist. Keep knees bent, not locked straight.
- Use legs for strength, not the weaker muscles of the back or arms. This will help prevent back strain.
- Do not twist at the waist. Keep the torso facing the same direction as the hips and move the feet to turn. This will help prevent back strain.
- Maintain a straight back. Hunching or rounding the shoulders can cause back strain.
- Do not hesitate to call for additional assistance if needed.
- If you do not feel comfortable with an activity you are requested to assist with (such as negotiating a step or a steep incline), you may decline to assist and should help find appropriate assistance for the occupant.

GENERAL USE INSTRUCTIONS

OPENING AND FOLDING THE TRANSPORT CHAIR

IMPORTANT NOTES:

There are potential finger pinch point areas at moving parts and between the seat frame and the seat cradles on some models. When opening the transport chair, take care not to place your hand or fingers between the seat frame and the seat cradles (if present) or on any other moving parts.

ALWAYS keep hands and fingers away from moving parts. DO NOT sit in the transport chair until the seat is completely in the open position. Risk of injury may occur if care is not taken.

To OPEN the Transport chair

1. Hold onto one armrest and push the opposite side to open the transport chair.
2. With your fingers and thumbs pointed towards the inside of the transport chair, push downward on the seat to ensure the transport chair is fully open. Keep hands and fingers away from any moving parts.

Alternative method to open the transport chair:

1. Tilt the transport chair to one side by grasping the hand grip or armrest nearest to you.
2. With fingers pointed away from the seat rail, push down on one side of the seat frame / rail until the transport chair is fully open. Keep hands and fingers away from any moving parts.

To CLOSE / FOLD the transport chair

1. Ensure the swing-away legrests are in the forward and locked position.
2. Fold the footplates up to the vertical position.
3. Using both hands, grasp the center of the seat upholstery at the front and back edge and lift the seat up.

GENERAL USE INSTRUCTIONS

Alternative method to close the transport chair:

1. Ensure the swing-away legrests are in the forward and locked position.
2. Fold the footplates up to the vertical position.
3. Grasp the handles/straps on each side of the seat.
4. Pull up until the transport chair is fully closed.
5. The handles can be used to carry the closed transport chair.

Folding / unfolding the seat back

The top portion of the transport chair seat back can be folded down for more compact storage.

Caution: DO NOT use the transport chair with the seat back in the folded down position.

seat back
release lever

seat back
release
assembly



seat back spring
button locked
in full upright
position

To fold the back down:

1. Pull back on the seat back release lever on each side of the transport chair back canes.
2. Fold the top portion of the seat back frame / upholstery down.

seat back spring
button unlocked



To return the seat back to the upright position:

1. Push the seat back up until the seat back release assembly spring buttons click fully into the folding mechanism on both sides. You should see the spring buttons fully engaged from the front of the seat back canes.
2. Ensure the frame / handles are locked securely into place before using the transport chair for transport.

GENERAL USE INSTRUCTIONS

WHEEL LOCKS

WHEEL LOCK WARNINGS

- Check the wheel locks to ensure proper function before using the transport chair. Wheel locks should embed into the wheel at least 1/8 inch when engaged.
- Engage the wheel locks on both wheels before entering the transport chair, leaving the transport chair, leaning forward in the transport chair or while being transported in an elevator or a transport chair lift.
- Check to make sure that the legrests do not unlock the wheel locks when they are swung back.
- **DO NOT** use the wheel locks (or hand grip locks if present) to stop the transport chair from moving. Wheel locks are not brakes. **DO NOT** use the wheel locks to slow your descent down an incline.

For models: MDS808150, MDS808200

To Engage the Wheel Locks

- Push forward on the wheel lock handle to UNLOCK the transport chair.
- Pull back on the wheel lock handle to LOCK the transport chair.

MDS808150
MDS808200

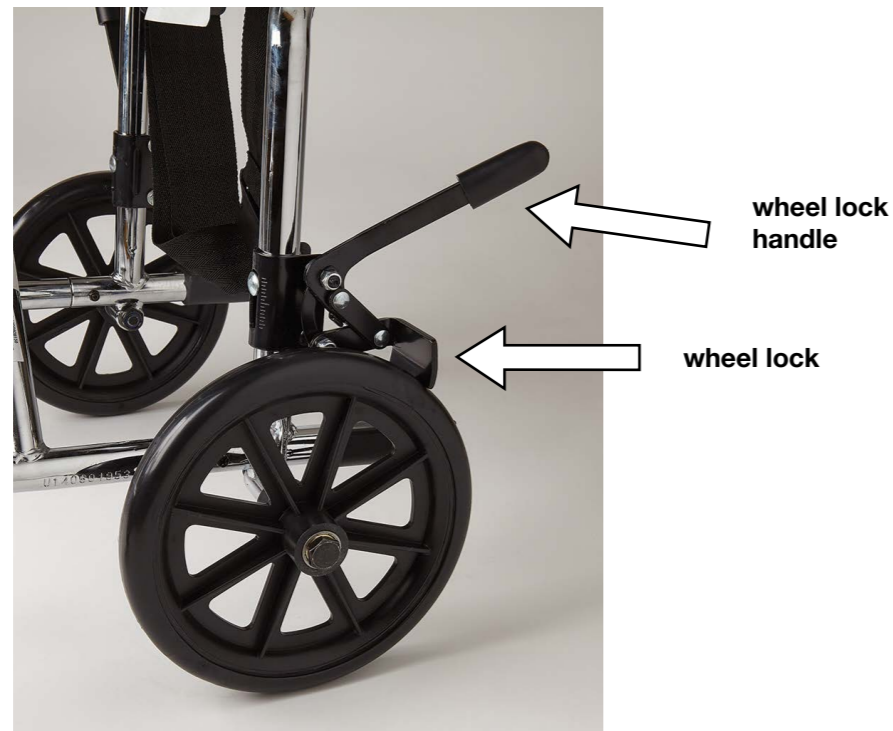

For models: MDS808200ARE, MDS808200ABE, MDS808200SLRR,
MDS808200SLBR, MDS808200SLKR, MDS808200SLSR

To Engage the Wheel Locks

- Pull BACK on the wheel lock handle to LOCK the transport chair.
- Push down on the wheel lock handle to UNLOCK the transport chair.

MDS808200ARE
MDS808200ABE



MDS808200SLRR
MDS808200SLBR
MDS808200SLKR
MDS808200SLSR

wheel lock



GENERAL USE INSTRUCTIONS

For models: MDS808210ARE, MDS808210ABE

To use Locking Hand Grip Brakes

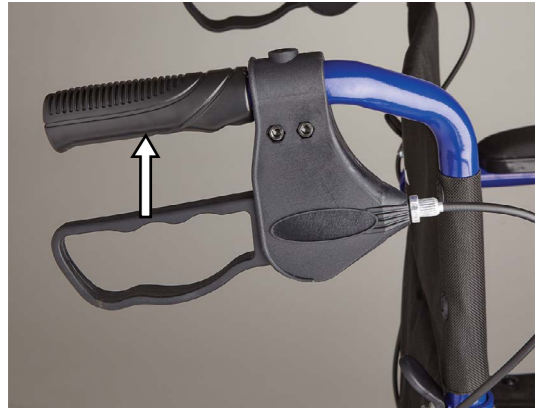

Handle grip wheel lock in open / unlocked position:

Squeeze brake to hold transport chair in stopped position.



Handle grip wheel lock in closed / locked position:

To Lock, push down on the handle until wheel lock engages

To Release, squeeze handle.

Installing the Swing-away Footrest Riggings

To Install the Riggings:

1. Hold the leg rest rigging to the side of the transport chair.
2. Slide one side of the leg rigging onto the hinge pins, swing the leg rigging out until it clamp locks into place. Repeat this step for the other leg rigging.



GENERAL USE INSTRUCTIONS

To Swing-away / Remove the footrest assembly:

1. Fold the footplate up to the vertical position.
2. Release the legrest lock by pulling on the legrest lever.
3. Swing the legrest outward and to the side.
4. To remove the legrest, lift up on the assembly to remove the legrest off the hinge pins.



To adjust the footplate assembly:

1. Loosen the plunger by pulling it out so it is perpendicular with the leg rest.
2. Engage the two push buttons by pushing them in and adjust the footplate assembly to your desired height. Release the push buttons and ensure they are protruded and locked in place.
3. Lock the plunger into place.

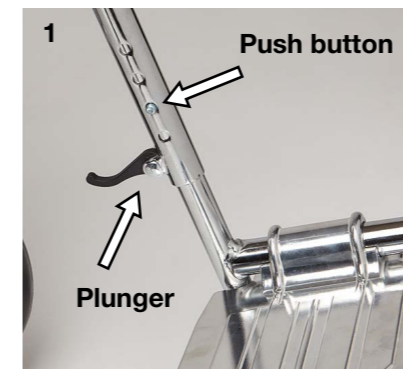

SAFETY INSPECTION & MAINTENANCE

It is highly recommended that the transport chair be taken to a qualified dealer annually for a thorough inspection and maintenance / repair service.

GENERAL CARE

- Wipe off chrome / aluminum parts at least once per week using a clean, soft cloth.
- Dry the transport chair immediately if exposed to moisture.
- Do not use abrasive cleanser or materials that will scratch the finish of the transport chair.
- Clean the upholstery with a mild soap solution, rinse and wipe dry.
- Clean the hand grips with water only and dry thoroughly. Use of soap or ammonia-based cleaning solutions may loosen the grips.

MONTHLY CHECK LIST / TROUBLESHOOTING

General:

Inspect the entire transport chair for broken parts, sharp edges and loose fasteners. Ensure that everything works and the transport chair rolls straight without drag and does not pull to one side. Replace or tighten parts as needed. Inspect for bent frame and crossbars.

Frame and Crossbraces:

Check that the frame and crossbraces are not bent or dented. Check the tubing for cracks and rust. ***If such issues are found, take the transport chair to your local service dealer.***

SAFETY INSPECTION & MAINTENANCE

Upholstery:

Inspect for any rips, tears or worn spots and replace as necessary. Inspect the upholstery screws and assure that all are present and tight. Torn or worn upholstery may not support the user's weight and could result in a fall with serious bodily injury.

Seat back:

Ensure the seat back folding mechanism is functioning properly and the seat back locks securely in the upright position.

Armrests:

Check for cracks, looseness, or sharp edges.

Hand grips:

Ensure the hand grips are tight and secure on the handles. They should not move or twist.

Footrests / Legrests:

Ensure the legrest assembly release works properly. Ensure the assembly automatically locks securely into place when attached and will not accidentally unlock.

Front Caster Forks:

Verify the forks swivel freely without binding. Check to ensure the casters roll freely by lifting the transport chair and spinning the caster. The caster should come to a gradual stop. If the nut is too loose, the caster will flutter or shimmy. If the nut is too tight, the transport chair will be difficult to steer. Check the bearings and clean the fork stem housing.

Front Casters and Rear Wheels:

Ensure the caster / wheel axle and nut are tight. The fork housing and the rear and front wheels are constructed with low maintenance, sealed bearings to keep dirt out and increase the durability of the transport chair. Bearings are also protected with an additional bearing spacer component. Check that the wheels are not warped, cracked or otherwise damaged and the spokes are not broken. Replace as needed. Assure that the wheels spin freely. Replacement and maintenance of wheel bearings should be completed by a qualified transport chair technician only.

Front and Rear Tires:

Solid tires require minimal maintenance. They should occasionally be cleaned with a damp cloth. Replace the tires if they become cracked, excessively worn, or have flat spots.

MAINTENANCE

Installing / Removing Front Wheels



1. Remove wheel axle and nut, using an allen wrench.
2. Be sure to replace with the proper size wheel.
3. Install wheel, axle, and nut. Check for loose parts before use.

Installing / Removing Rear Wheels

WARNING:

After changing a rear wheel, check wheel locks for proper adjustment before use.



1. Remove hubcap if present.
2. Remove wheel axle and nut.
3. Be sure to replace with the proper size wheel.
4. Install wheel, axle, and nut.
5. Check wheel locks for proper adjustment after changing the wheel.

Wheel Locks

Check to ensure both locks engage correctly and embed in the tire at least 1/8 inch. If the lock is worn or damaged, it needs to be replaced. Make sure the locking assembly is securely attached to the frame and the wheel will not move when the lock is engaged. Make sure the wheel lock does not interfere with wheel rotation when the lock is not engaged. See wheel lock adjustment instructions in the General Use section.

MAINTENANCE

Hand grip wheel locks (select models):

Check to ensure the hand grips cause the wheel locks to engage correctly and embed in the tire at least 1/8 inch. If the lock is worn or damaged, it needs to be replaced. Make sure both the intermittent and full lock functions work by testing the hand grips in both the up and down positions. Ensure the transport chair will not move when the hand lock is engaged. Make sure the wheel lock does not interfere with wheel rotation when the lock is not engaged. See wheel lock adjustment instructions in the General Use section.

CAUTIONS:

Use only Medline Industries, Inc. authorized accessories and parts.

DO NOT modify the transport chair. Examples: drilling holes, grinding, welding parts, using non-authorized / non-approved parts. Such modifications may change the transport chair's structure and center of balance, which may increase the risk of serious injury to the user and void the warranty.

MEDLINE LIMITED WARRANTY

Medline has great confidence in the quality of our transport chairs. That is why Medline warranties for the original purchaser, that the frame of the transport chair will be free from defects in materials and workmanship for the life of the transport chair.

Medline also warrants the parts and upholstery on the transport chair to be free from defect in materials and workmanship for a period of one (1) year from date of purchase by the original purchaser.

If within the warranty period any such product shall be proven to be defective, such product shall be repaired or replaced, at Medline's option.

This warranty does not cover device failure due to owner misuse or negligence, or normal wear and tear.

All warranty claims must include the product in question unless otherwise authorized by Medline.

For more information about your transport chair, warranty or to reorder parts call 1-800-MEDLINE.

MAINTENANCE

SAFETY INSPECTION CHECKLIST

ITEM	INITIALLY	INSPECT / ADJUST WEEKLY	INSPECT / ADJUST MONTHLY	INSPECT / ADJUST PERIODICALLY
GENERAL Chair rolls straight. (no excessive pull to one side)	X			X
CLEANING Wipe chrome parts with clean, soft cloth. Auto wax / similar product on metal parts. Clean upholstery with mild soap solution. Use only water on hand grips. Dry chair immediately when wet.		X X X		
FRAME & CROSS BRACES Inspect for loose or missing hardware. Inspect for bent frame or cross braces.	X X			X X
SEAT AND BACK UPHOLSTERY Inspect for rips or sagging. Inspect for loose or broken hardware.	X X		X	X
RECLINER Inspect reclining mechanism to ensure they are clean and work freely. Ensure stabilizer bar engages securely.	X X			X X
FRONT CASTERS AND REAR WHEELS Inspect wheel / fork assembly for proper tension by lifting the chair and spinning the caster. It should come to a gradual stop. Loosen locknut if wheel wobbles / tighten locknut if wheel binds to a stop. Ensure wheel bearings are clean and free of moisture.	X X X	X X		X
REAR WHEELS No excessive side movement or binding when chair is lifted and wheels are spun.	X		X	
FRONT AND REAR TYRES Inspect for flat spots and wear.	X	X		
HAND GRIP WHEEL LOCKS (If equipped) Test in both complete and intermittent lock positions. Ensure the chair does not move when the locks are engaged.	X		X	
WHEEL LOCKS Do not interfere with tires when rolling. Pivot points free of wear and looseness. Wheel locks are easy to engage.	X X X		X X X	
LAP BELT Inspect for secure attachment. Inspect for worn or frayed belt.	X X	X X		

Take the wheelchair to a qualified dealer annually for a thorough inspection and maintenance or repair services.

Your Authorized Service Facility:

Record your Serial Number:

www.Medline.com
© 2015 Medline and Excel are registered trademarks of Medline Industries, Inc.
Medline Industries, Inc., Mundelein, IL 60060 USA